

ZN73S-24
Indoor High Voltage
Vacuum circuit breaker



Description

ZN73S-24 Indoor high voltage vacuum circuit breaker is suitable for the indoor distribution equipment of 24kv, three phase AC50Hz, it is mainly used to break and close the load current, over current and short-circuit current in the circuit, plays a control and protection role, and it's the main switch components of medium central switchgear. It is used for protection and control in power distribution systems of substations, enterprises and industrial and mining enterprises. It is suitable for rural power grids and places with frequent operations, especially for the needs of urban and agricultural network transformation.

Main function characteristics

- The circuit breaker adopts copper-chromium contact material and a cup-shaped longitudinal magnetic field contact structure. The electrical wear rate of the contacts is small, the dielectric insulation strength is stable, the recovery after arc is rapid, the cut-off level is low, the breaking ability is strong, and the electrical life is long.
- The operating mechanism is a spring energy storage mechanism arranged in a plane, which has manual energy storage and electric energy storage functions to make the operating performance of the circuit breaker more reliable.

Model No.

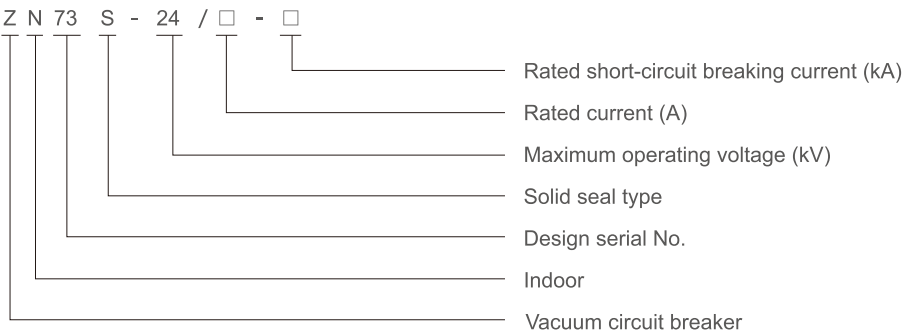

Main technical parameters and characteristic parameters of circuit breaker

No.	Name	Unit	Parameter		
1	Rated voltage	kV	24		
2	Rated frequency	Hz	50		
3	Rated current	A	630	1250	1600,2000, 2500
4	Rated short-circuit breaking current	kA	20	25	31.5
5	Rated peak withstand current	kA	50	63	80
6	Rated short time withstand current	kA	20	25	31.5
7	Rated short-circuit closing current	kA	50	63	80
8	Rated operation sequence		O-0.3s-CO-180s-CO		
9	Mechanical life	Cycles	10000		

VACUUM CIRCUIT BREAKER

ZN73S-24

Indoor High Voltage
Vacuum circuit breaker

No.	Name	Unit	Parameter
10	Rated number of short circuit breaks	cycles	20
11	Power frequency withstand voltage 1min	Interphase, ground/break kV	65/79
12	Lightning shock withstand voltage	Interphase, ground/break kV	125/145
13	Allowable wear thickness of moving and fixed contacts	mm	3
14	Contact opening distance	mm	14±1
15	Contacts stroke	mm	4±1
16	Average opening speed (6mm just after opening)	m/s	1.3±0.2
17	Average closing speed (6mm just before closing)	m/s	1.0±0.2
18	Contact closing bounce time	ms	≤2
19	Three-phase opening and closing synchronicity	ms	≤2
20	Main loop resistance (without touch arm)	μΩ	≤45
21	Closing time	ms	35-70
22	Opening time	ms	20-50
23	Interphase center distance	mm	210±0.5, 275±0.5

Overall and installation dimensions

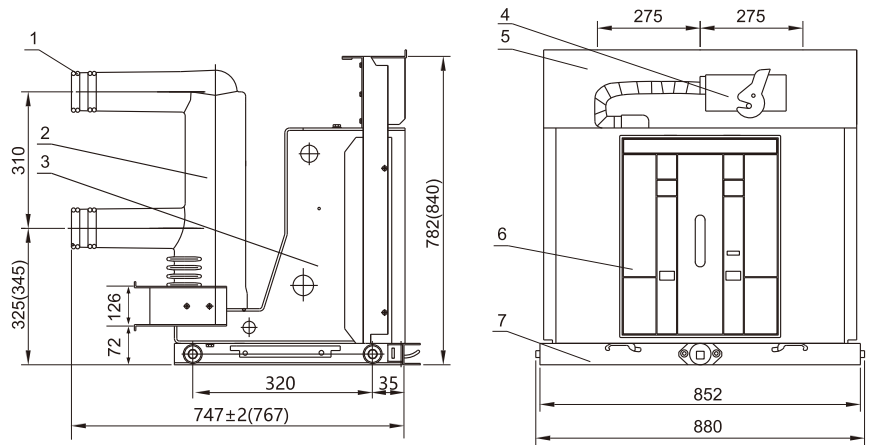

1. Plum blossom contact 2. Vacuum interrupter pole 3. Mechanism frame
4. GDZ-58 plugs and sockets 5. Fixing plate 6. Mechanism panel 7. Pull-in/out trolley

Note: The pull-in stroke of the drawer is 300mm, and the size in the brackets is the outer drawing of the rated current above 2000A.